

Let's get started.

Install on your Amazon Firestick.

1

Plug the Firestick into one of the HDMI ports on your television, and other end into an electrical outlet. (Helpful hint - ports are usually positioned around the side or on the back of your television.)

2

Use the Amazon remote to find and select the search icon. Type in "CDE" and select "Next" then proceed to install the app.

3

Find and select the CDE Lightband to launch the app once it's downloaded.

4

You will be prompted to enter in your Password and User ID on the next two screens. This can be found in your installation kit or in the confirmation email from your CDE Representative.

5

You are ready to enjoy TV Streaming! Simply select the CDE Lightband app anytime from the home page to watch.

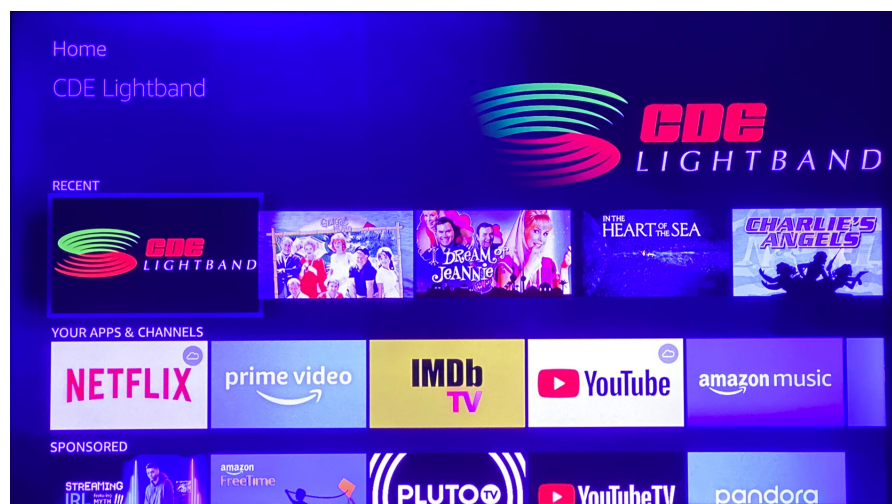

Stuck somewhere on the installation? Call us anytime for help 931.648.8151

Let's get started.

Install on your Apple Device.

1

Go to the App store on your device. Search "CDE" in the search bar.

2

Install app on your device, open the app and follow the prompts to add in your Password and User ID. These are provided in the email you received from your CDE Representative.

3

Find and select the CDE Lightband to launch the app once it's downloaded. Enjoy!

Homepage

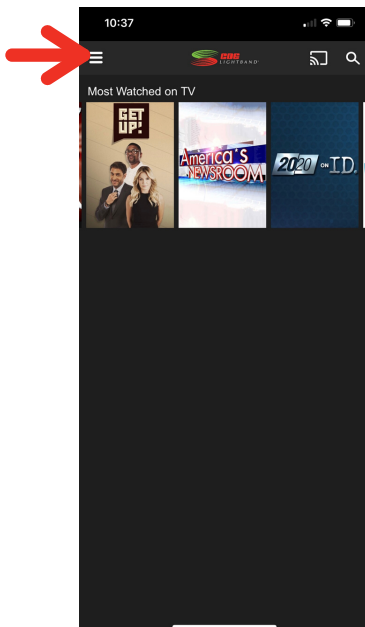

Navigation Bar

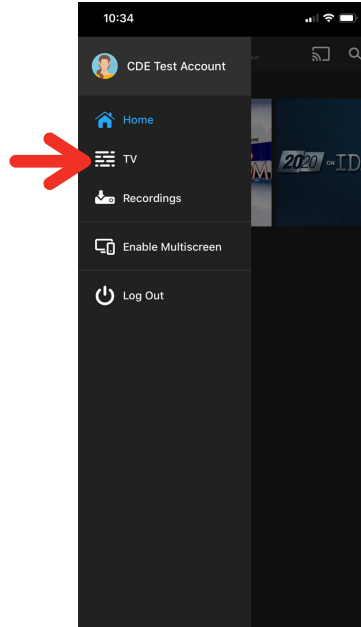

Channel Lineup

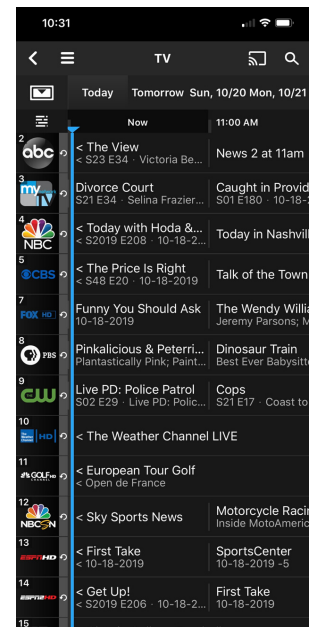

Let's get started.

Install on your Android Device.

1

Go to the App store on your device. Search "CDE" in the search bar.

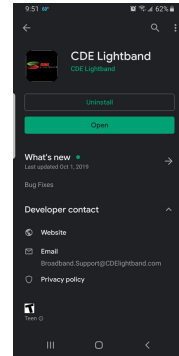

2

Install app on your device, open the app and follow the prompts to add in your Password and User ID. These are provided in the email you received from your CDE Representative.

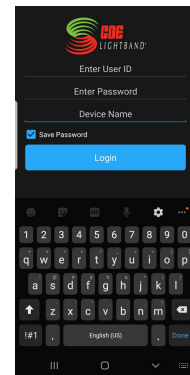

3

Find and select the CDE Lightband to launch the app once it's downloaded. Enjoy!

Homepage

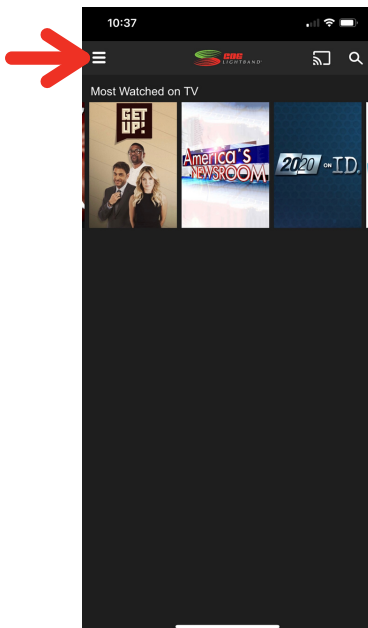

Navigation Bar

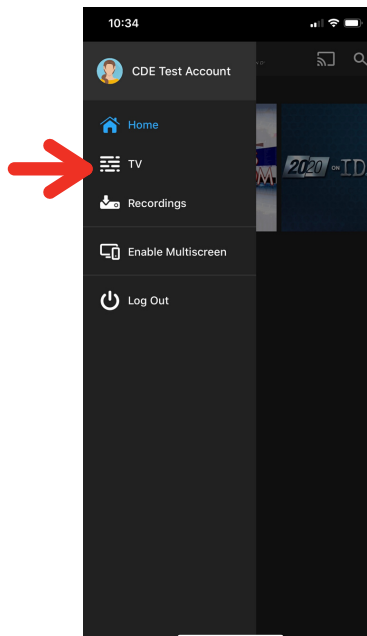

Channel Lineup

